

Substrate: AR Building Solutions Megaboard Medium Density

Interior/Exterior: Exterior

Finish: GranoShield® Matt Low Profile (Water Based)

PAGE 1 OF 3
VERSION 1
AUGUST 2015**Product Description**

GranoShield® Matt is a pure acrylic matt finish, high performance elastomeric coating.
GranoShield® Matt is approved to APAS 0117/3 & 0118/2.

Surface Preparation

Substrate must be free from dirt, dust, oil, grease, mould or any other contaminants that may affect adhesion. Wash the surface to remove any powdery material. Ensure the AR Building Solutions Megaboard Medium Density panels are securely fixed in accordance with the manufacturers specifications. Examine panels to ensure that there is no possibility of future sheet movement. Set joints as per diagrams on page 2. Apply GranoPrime® to the entire surface. Set joints as per diagrams on page 2. Trowel GranoSponge® Fine Acrylic (G1.21) over the entire surface as a preparatory product, as outlined below.

Coatings System

Application Details	Data Sheet	Coverage	Film Thickness		Dry Times	
			Wet	Dry	Touch	Topcoat
Primer / base Coat: GranoPrime® <i>(equipment: roller or spray)</i>	G1.02	12.5 m ² /L	80	20	1-2 hours	2-6 hours
Joint setting: GranoFlex® Jointing System <i>(equipment: stainless steel trowel)</i>	G1.15		SEE PAGE 2 Diagram and PAGE 3 Additional Notes			
Preparatory / texture coat: GranoSponge® Fine Acrylic <i>(equipment: stainless steel and red plastic trowel)</i>	G1.21	1.0 m ² /L (per 1mm)	2280	1300	4 hours	24 hours
1 st Topcoat: GranoShield® Matt <i>(equipment: roller or spray)</i>	G2.27	4.0 m ² /L	250	117	4 hours	6 hours
2 nd Topcoat: GranoShield® Matt <i>(equipment: roller or spray)</i>	G2.27	4.0 m ² /L	250	117	4 hours	6 hours

Granosite jointing systems for AR Building Solutions Megaboard Medium Density Panels

GRANOFLEX® JOINTING SYSTEM

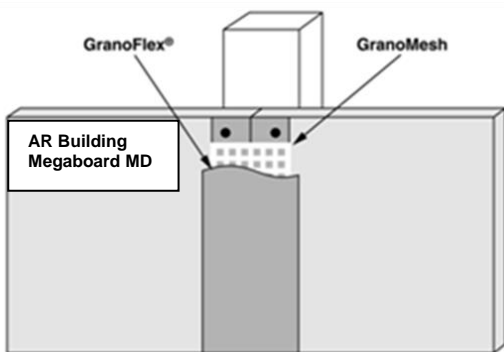

Joint Preparation

Thoroughly mix 20% grey builder's cement by volume into the Granoflex® (G1.15). Place the Granomesh™ into the recessed area and, trowel Granoflex® (G1.15) over the Granomesh™ ensuring that the mesh is fully encapsulated and flush with the sheet face. Allow to dry for 24 hours.

Products	Material usage rate per lineal metre
Granoflex®	0.25 kg
Granomesh™	1 metre

GRANOFLEX® CORNER PREPARATION

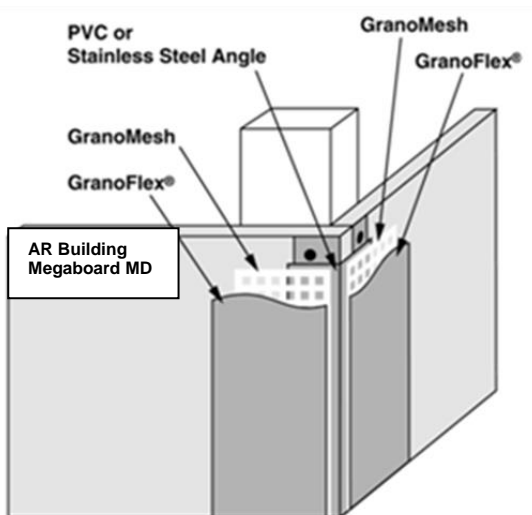

Corner Joint Preparation

Thoroughly mix 20% grey builder's cement by volume into the Granoflex® (G1.15). Place Granomesh™ into the recessed area and, trowel Granoflex® (G1.15) over the Granomesh™ ensuring that the mesh is fully encapsulated and flush with the sheet face. Allow to dry for 24 hours.

Products	Material usage per lineal metre
Granoflex®	0.20kg
Granomesh™	2 metres

Additional Notes

The success of any jointing system is very much dependent on the correct construction techniques, the fixing of the panels and the application of the jointing materials themselves. Valspar recommends, that it is the responsibility of the Applicator to ensure that the substrate is of an acceptable standard prior to the application of any Granosite coating system.

Surface preparation is the responsibility of the Builder, Renovator or Main Contractor and the Applicator. To achieve the indicated performance, it must be carried out according to Valspar's recommendations.

It is recommended that application be carried out by a skilled applicator, who is totally conversant with the Valspar Granosite products and systems, to validate full material warranty conditions.

Texture coatings will only follow the contour of the substrate, therefore in certain light conditions joints or imperfections may be apparent (Glancing or Critical Light). This is an industry issue and is not product related. Careful consideration should be given to the condition of the substrate, texture and skill of the applicator prior to application.

Dark colours will give excessive heat absorption. To avoid this, it is recommended that the topcoat colour have a Light Reflective Value (LRV) of greater than 40%.

Caution:

Provide adequate ventilation during use.

Application should not be carried out if the air temperature or the substrate temperature is below 10°C or above 35°C.

The temperature must not fall below 10°C during the drying process.

REFER TO PRODUCT TECHNICAL DATA SHEETS AND SAFETY DATA SHEETS FOR FURTHER INFORMATION ON THE PRODUCTS MENTIONED IN THIS SPECIFICATION SHEET

1. This information is provided with respect to the listed Solver products. Valspar (WPC) recommends that:

(a) you review the Technical Data Sheets (TDS) and Safety Data Sheets (SDS) before you use or handle the product; (b) the product be used only in accordance with the information provided by Valspar; (c) the product be transported, stored and handled in accordance with the information on the SDS and relevant TDS; and (d) you thoroughly test the product, using the recommended application method on a sample of intended substrate, before using the product.

2. The information in this specification sheet was prepared using information gathered during product development. While Valspar endeavours to update this information and maintain the accuracy and currency of its contents, Valspar cannot guarantee that the information provided is wholly comprehensive.

3. Valspar recommends that you conduct such additional investigations as may be necessary to satisfy yourself of the accuracy, currency and comprehensiveness of the information on which you rely in using and handling the product. If you require further information please contact your nearest Valspar Office.

4. To the full extent permitted by law, Valspar's liability for breach of a condition or warranty implied into the contract for sale between Valspar and you by law is limited at Valspar's election to: (a) the replacement of the product; or (b) payment of the cost of replacing the product.

Wattyl, Granosite are registered trademarks of Valspar Paint (Australia) Pty Ltd ABN 40 000 035 914. Solver, Solver Ultra are registered trademarks of Valspar (WPC) Pty Ltd ABN 65 007 527 371.

INFORMATION HOTLINE: Ph: 132 101 (AUSTRALIA)